



REC-GUD-009	Public Pools and Water Attractions
Revision: 1.0	Guidance for Enclosure Entries
Approved: Oct 11 2020	Wis. Admin. Code § ATCP 76

SUBJECT: Guidance for Enclosure Entries

Scope

This document is to assist sanitarians in identifying where self-closing, latching and lockable gates are required at any public pool and/or water attraction, as well as entries where self-closing, latching and lockable may only be recommended.

Definitions

‘Enclosure’, based on common usage of the word, means a permanent barrier constructed to separate the pool and/or water attraction area from the rest of the building or premises.

Guidance

This guidance shows some examples of various types of pool areas, whether the pool and/or water attraction is in a building used for another purpose, or whether the pool area is a stand-alone construction.

Requirements are based on year-built. If any specification cannot be required, for example, because the construction occurred before a requirement was in applicable code, the specification should nevertheless be recommended to the operator.

Chapter 76.34 (4) states ‘All pools areas shall be enclosed and have self-closing and latching gates or doors that are lockable.’ This requirement, however, was not always in the code for the operation of public pools and water attractions.

September 1978 is when ‘lockable’ first became a requirement for any pool in the pool code as administered by the Department of Health and Social Services.

December of 1989 is when *outdoor* pools were first required by the Department of Commerce to have a self-closing, latching and lockable gate or door.

February of 2008 is when ‘self-closing, latching and lockable’ became required by the Department of Health Services for an entrance to a pool.

In February of 2017, the Department of Safety and Professional Services began to require separation of a pool area so that the immediate pool area would be enclosed by a barrier or fence. This requirement affects hotel pools as pool areas can no longer be directly connected to guest rooms.

How to use the Guidance charts

The following diagrams show where self-closing, latching and lockable doors should be in place. Whether or not they can be required or recommended is going to depend on when the pool was constructed (see above), and sometimes if the pool is indoor or outdoor (see above).

First refer to the diagram to see what should be in place, then obtain information about when constructed and indoor or outdoor to determine what is required. Make a recommendation if self-closing, latching and lockable doors should be in place per the diagram (as indicated by ) but cannot be required.





In certain cases where attendants and/or lifeguards are present, a variance may be possible if the requirement for self-closing, latching, and lockable cannot be met. Please contact the program for help with the variance process (see Contacts below).

Building used for other purpose(s)

If the pool and/or water attraction is in a building that is used for other purposes, the entry for the building is going to be different from the entry to the the pool(s) and/or water attraction(s). We are focusing on the primary entry to the *pool area* or *enclosure*. There will be doors to get into and around the building---but the doors or gates we are primarily concerned about are those immediately between any other area and the pool enclosure or pool area itself.

Hotels, Motels, Apartments, Health Clubs

For these locations, there is another obvious use of the building other than for swimming. For example, someone enters a hotel to stay overnight, so there are guest rooms, conference rooms, and other areas as well as the pool and pool area. For these locations, the entry to the building is generally not the entry to the pool area—there must be a separate self-closing, latching, and lockable door for any entry from the rest of the building outside of the enclosure to the pool area. Guest rooms that must be accessed via the pool area are an exception (see below). A primary entrance to the enclosure is an entrance from someplace else in the building. If it is an entrance from someplace else to the enclosure directly, then it must be self-closing, latching and lockable.

Any type of door, gate, entry 	Self-closing, latching, lockable door or gate 
Body of water (MAHC 'Aquatic Venue') 	Pool enclosure (MAHC 'Aquatic Facility') 
Primary Building (school, apartment building, hotel, motel, etc) 	

Example A. Health club with enclosure, locker rooms within enclosure.

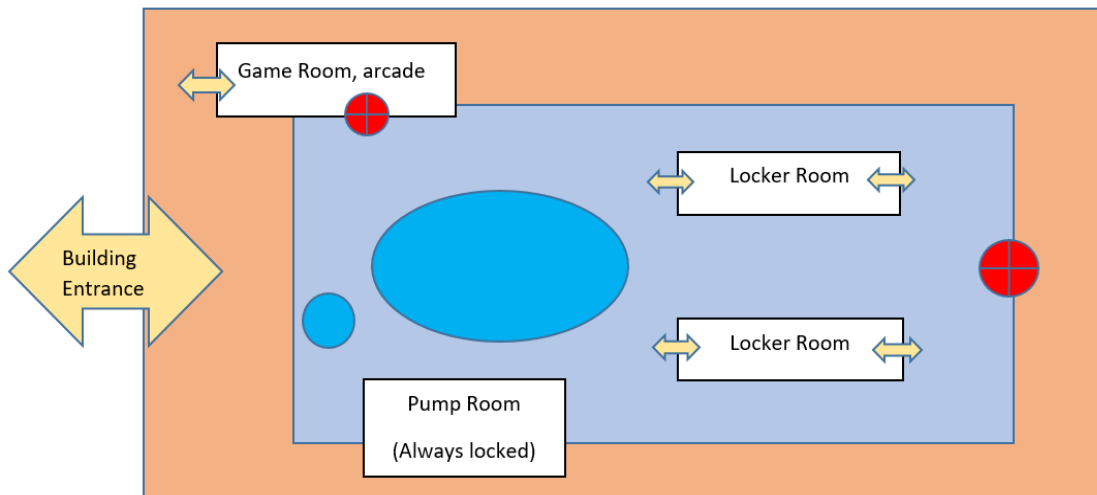



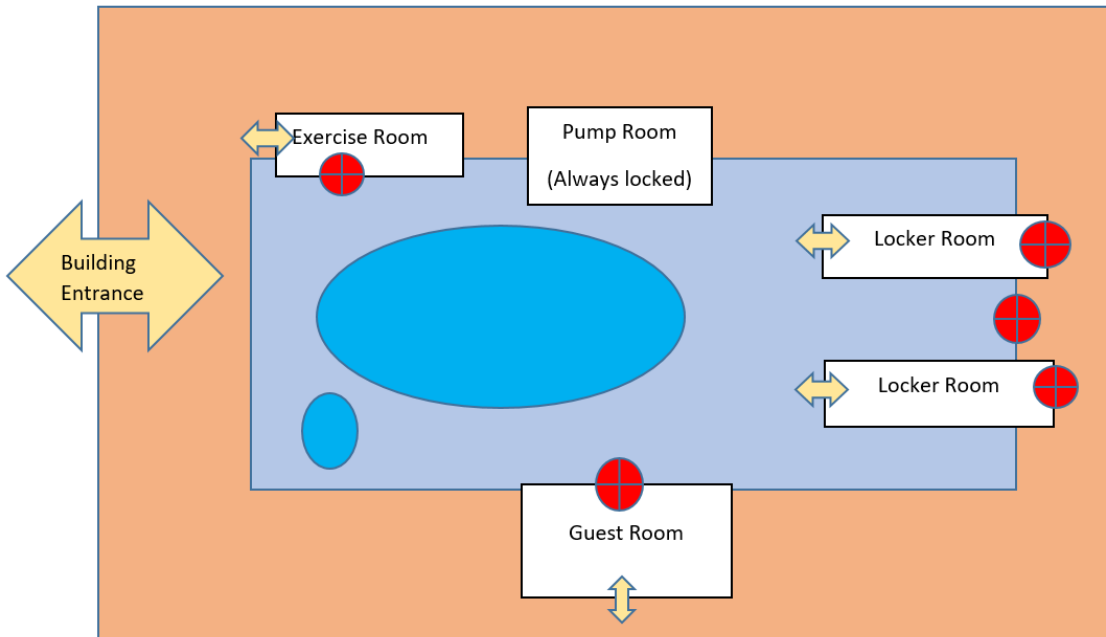
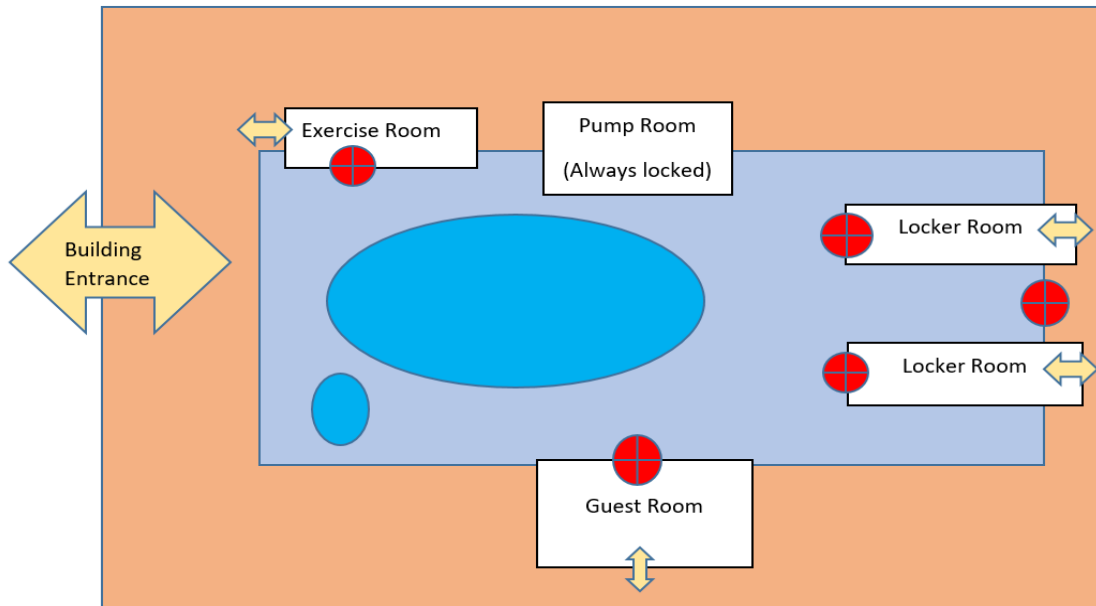

Example B. Spa hotel with locker room entrances, a main entrance—and guest room entrances to enclosure. Guests can also access their rooms from the hallway.

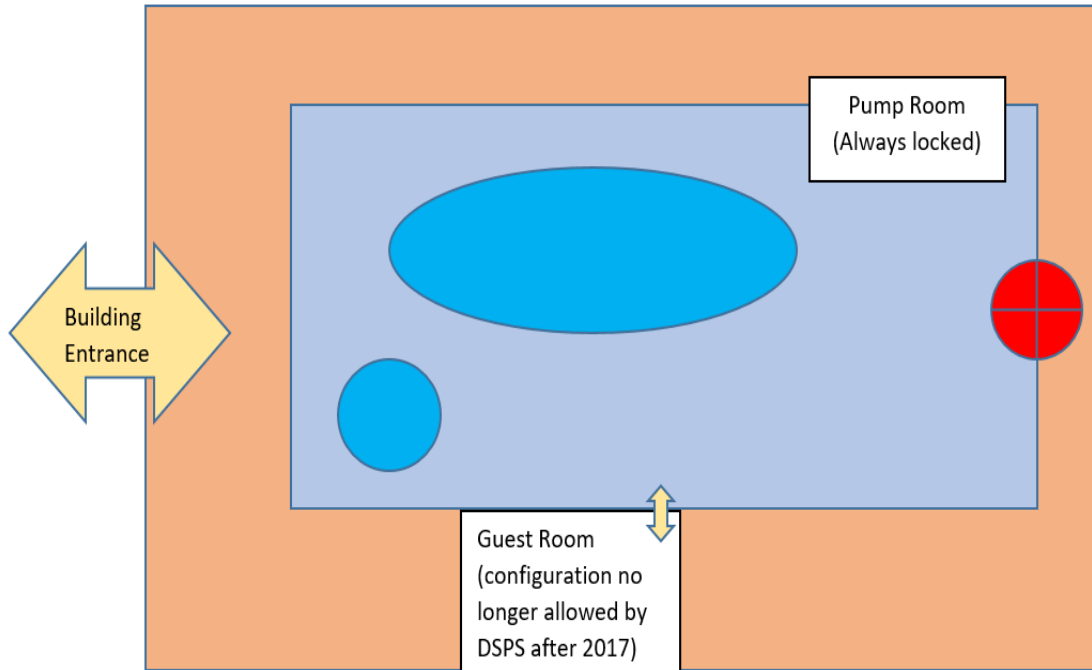

Example C. The hotel guest room is accessed via the pool enclosure. There is no other way to enter the guest room. In this case, we strongly recommend signage or other effective communication to guests so that they do not enter the pool when unsafe (undergoing superchlorination or other maintenance, under repair, hazardous material in pool or on deck), and also to closely supervise their children.



If there is no other building and the primary purpose of what is constructed is the public pool and/or water attraction, the entrance to the 'building' is going to be the entrance to what we call the *pool area* or *enclosure*, or, as the MAHC describes it, the '*aquatic facility*.'

Any type of door, gate, entry 	Self-closing, latching, lockable door or gate 
Body of water (MAHC 'Aquatic Venue') 	Pool enclosure (MAHC 'Aquatic Facility') 

Example D. Pool enclosure with locker rooms within the enclosure, accessed within the enclosure. The only door to the outside is the one to the pool area.

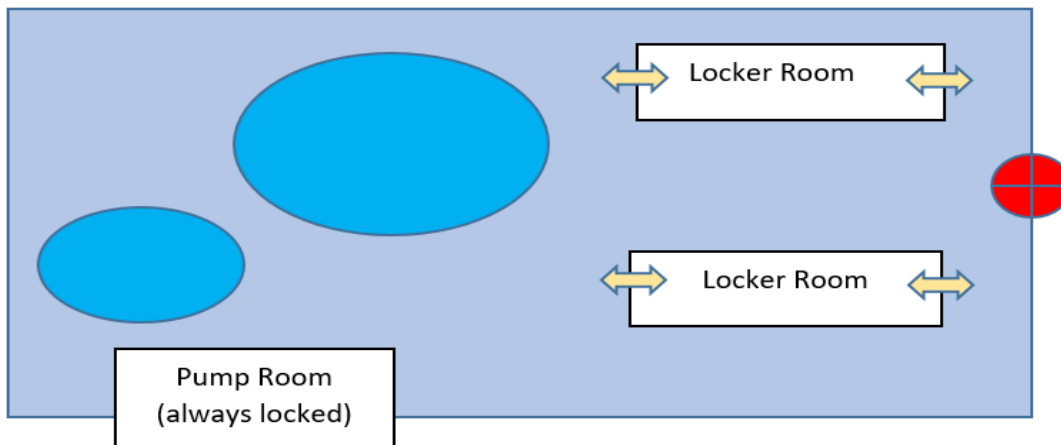

Example E. Pool accessed from outside via locker rooms or main entrance

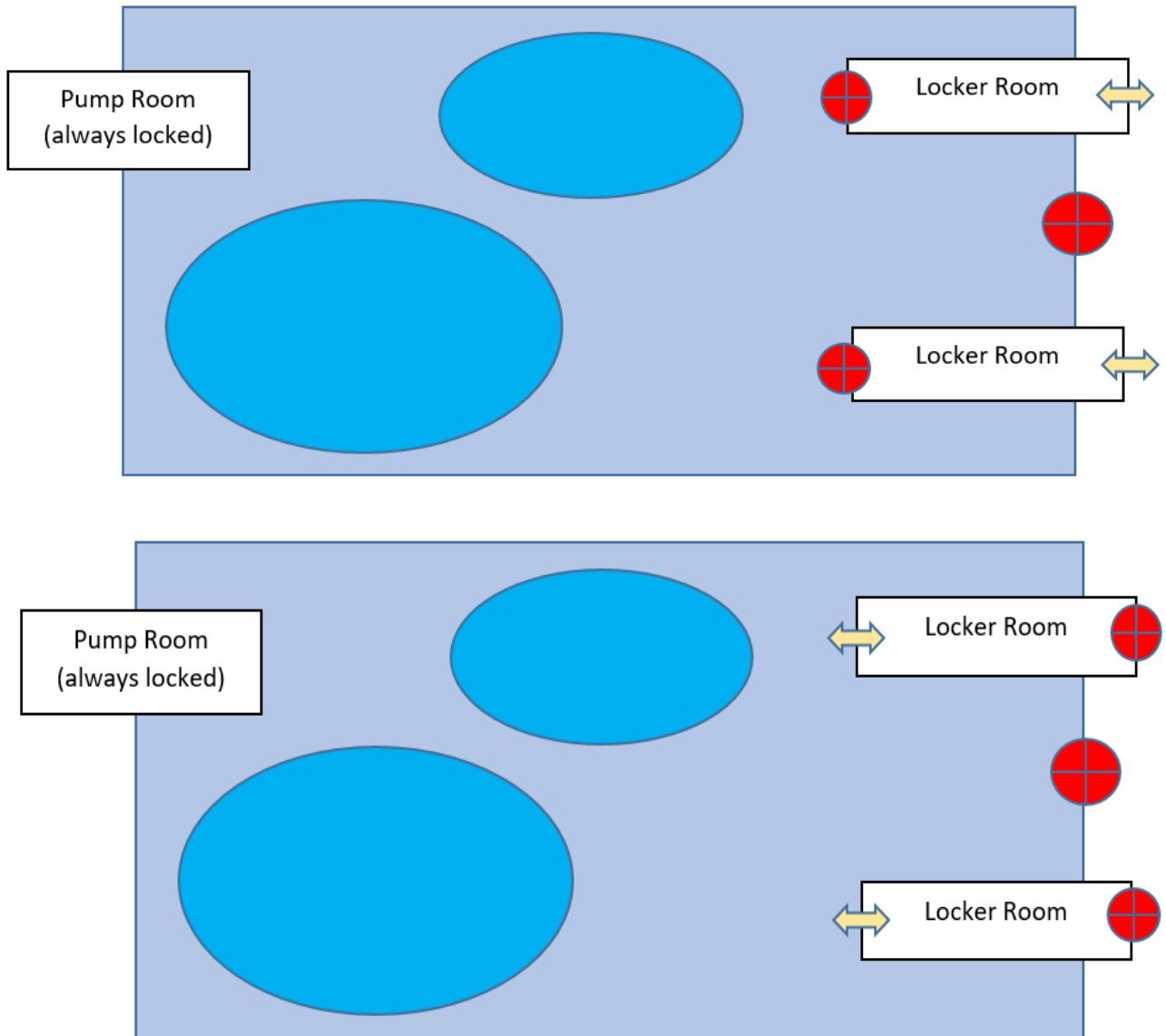

Example F. Typical municipal pool or waterpark. There may be a main entrance but then a waiting or check-in area before the enclosure.

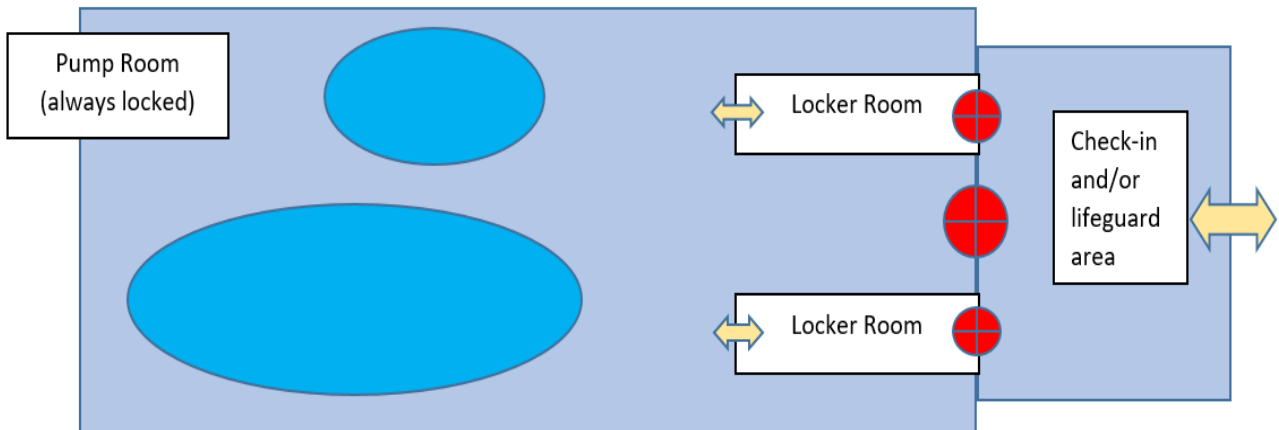
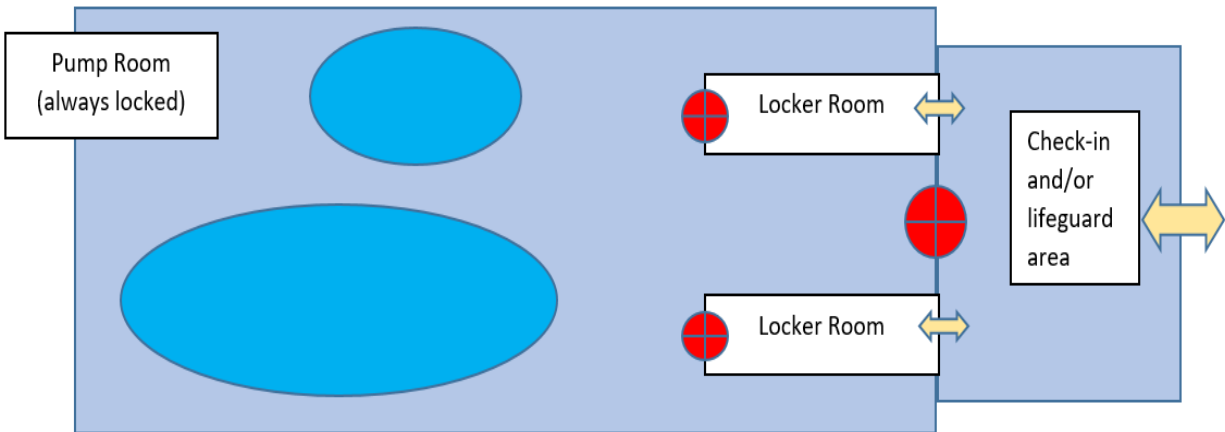

Configurations not described above: please contact the Rec Box as listed below.

Contacts

DFRS Recreational Technical Specialists: datcpdfsrec@wisconsin.gov.

References

Wis. Admin. Code Chapter ATCP 76